

R+2 - PLAN - LOGEMENT N° 10

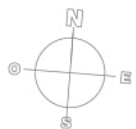

SARL LE LYNX - 14 VIA NOVA - 03610 FRÉJUS

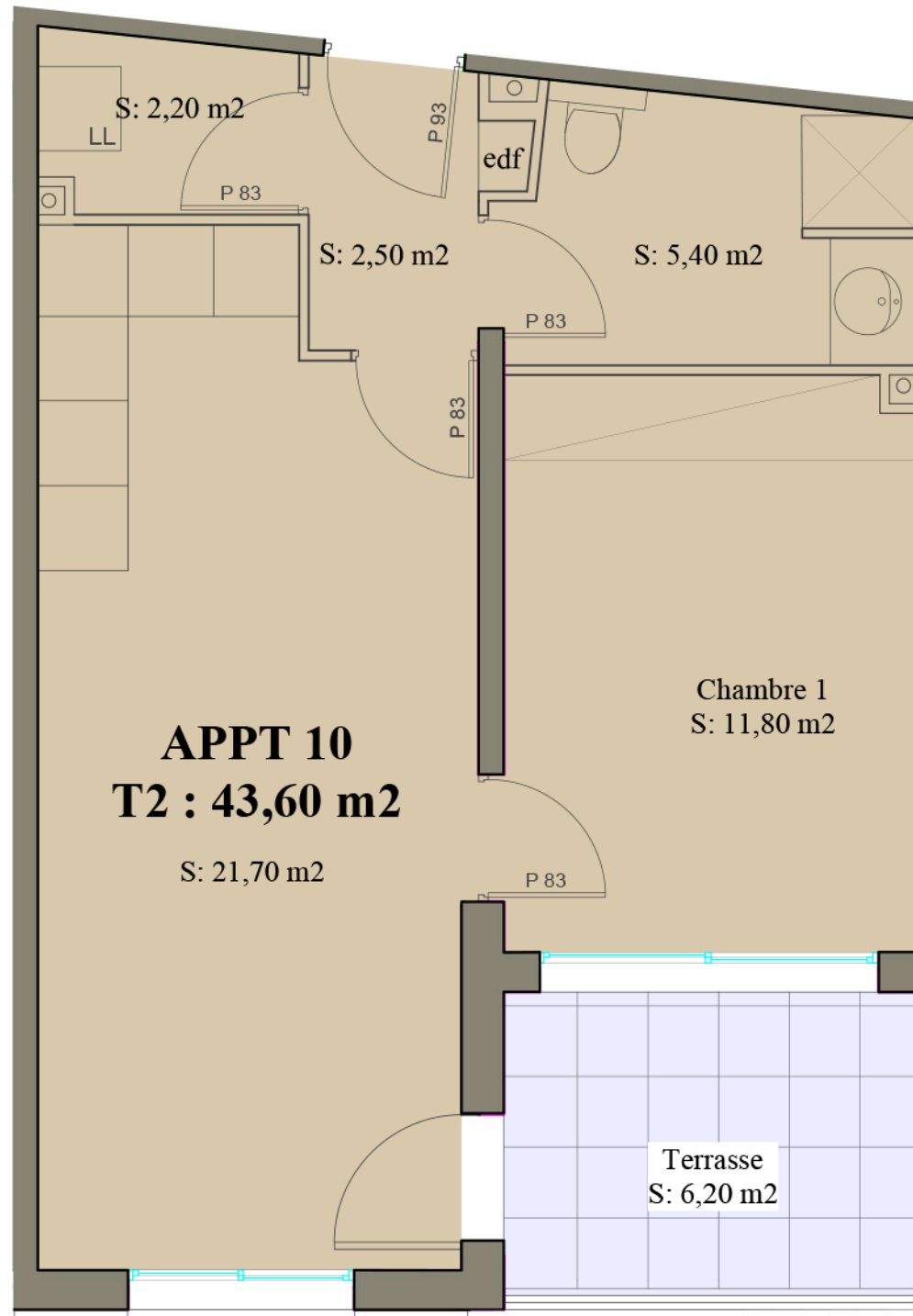

ECH : 1/50

R+2



Logement n° 10 - T2

SURFACES

Séjour/repas	21,70 m2
Entrée	2,50 m2
Cellier	2,20 m2
Salle de bain	5,40 m2
Chambre 1	11,80 m2

Total
surface habitable **43,60 m2**

Terrasse **6,2 m2**

